

NO.	1	RELOCATE AIR VENT
APPROVED	<i>[Signature]</i>	REVISION
REGISTERED CIVIL ENGINEER NO.	13653	DATE
DRAWING NO.	3344	CHECKED BY
SHEET	1	RECOMMENDED BY
OF SHEETS	6	

DEPARTMENT OF ENGINEERING
 CITY OF SAN BERNARDINO
 MAY 5, 1964
 APPROVAL
 FORTIETH STREET
 Between Harrison Street and Mountain Avenue
 W.L. WILSON

PROFILE

1" = 20'

Stationing	Top of Curb	Top of Air Vent	Flow Line
0+00 E.C.	1355.92	1355.25	1355.92
0+10	1356.06	1355.39	1356.06
0+20	1356.82	1355.95	1356.82
0+30	1357.11	1356.44	1357.11
0+40	1357.70	1357.03	1357.70
0+50	1358.30	1357.63	1358.30
0+60	1358.92	1358.15	1358.92
0+70	1359.23	1358.56	1359.23
0+80	1359.37	1358.90	1359.37
0+90	1360.20	1360.03	1360.20

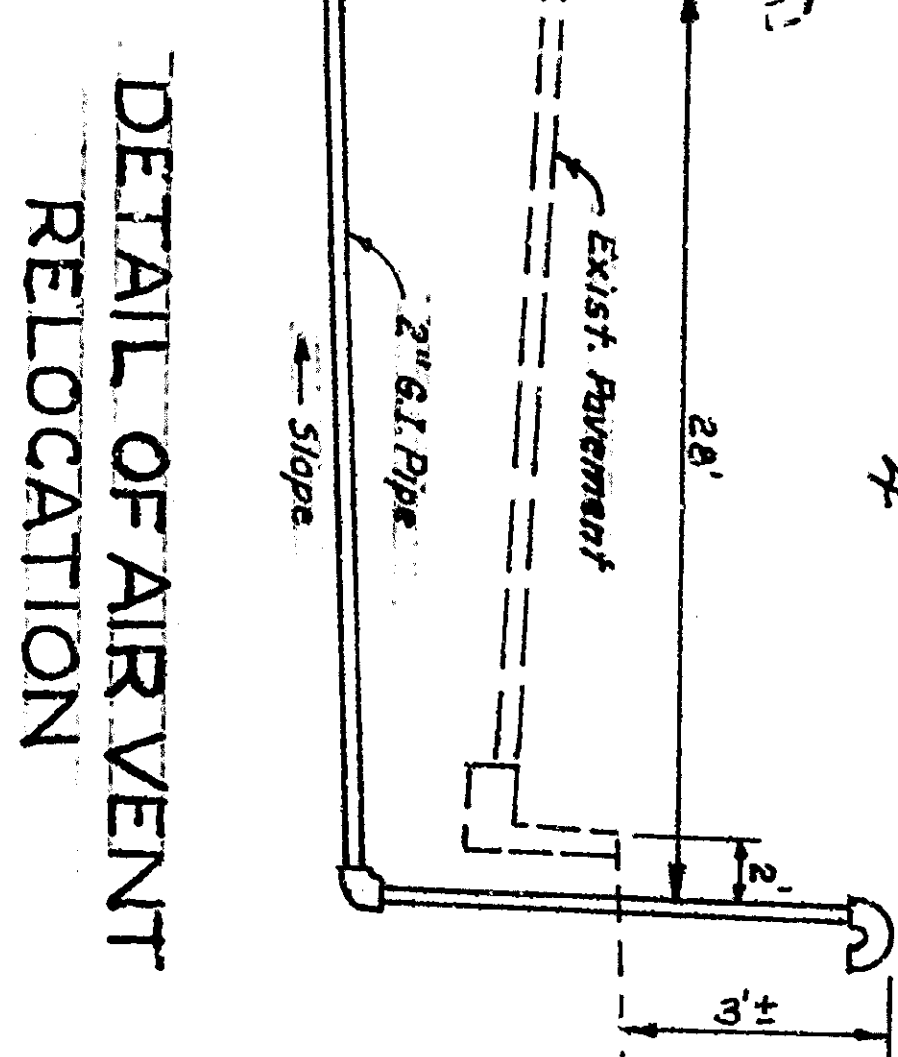
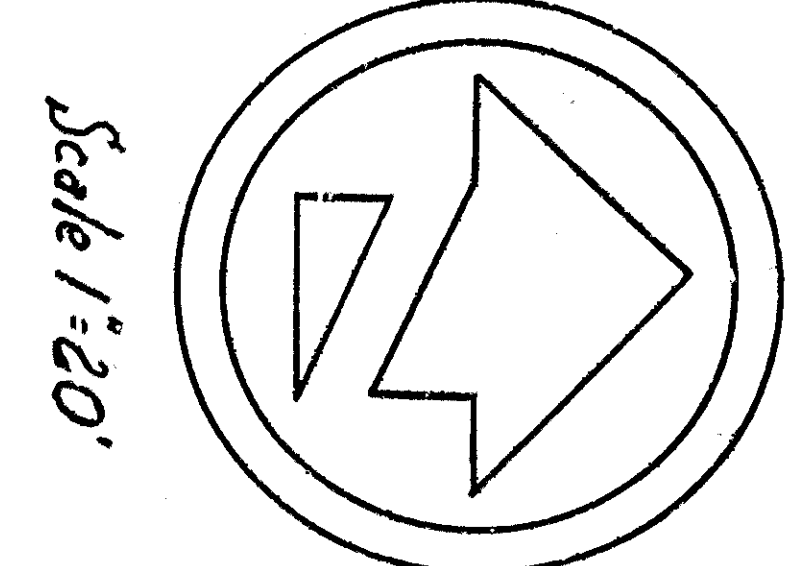



NO. 1	RELOCATE AIR VENT	
APPROVED	REVISION	DATE
3344		MAY 5, 1964
CITY OF SAN BERNARDINO		
DEPARTMENT OF ENGINEERING		
FORTIETH STREET		
Between Harrison Street and Mountain Avenue		
W.L. ...		

9'-0" End of Sidewalk
 RR # 129655 E
 9'-0" End of Curb & Gutter

Frame Stucco House

30' Olive Tree

REC. Q/W

5'-6" Lamp Post
 4'-0" Olive Trees
 30' Olive Tree

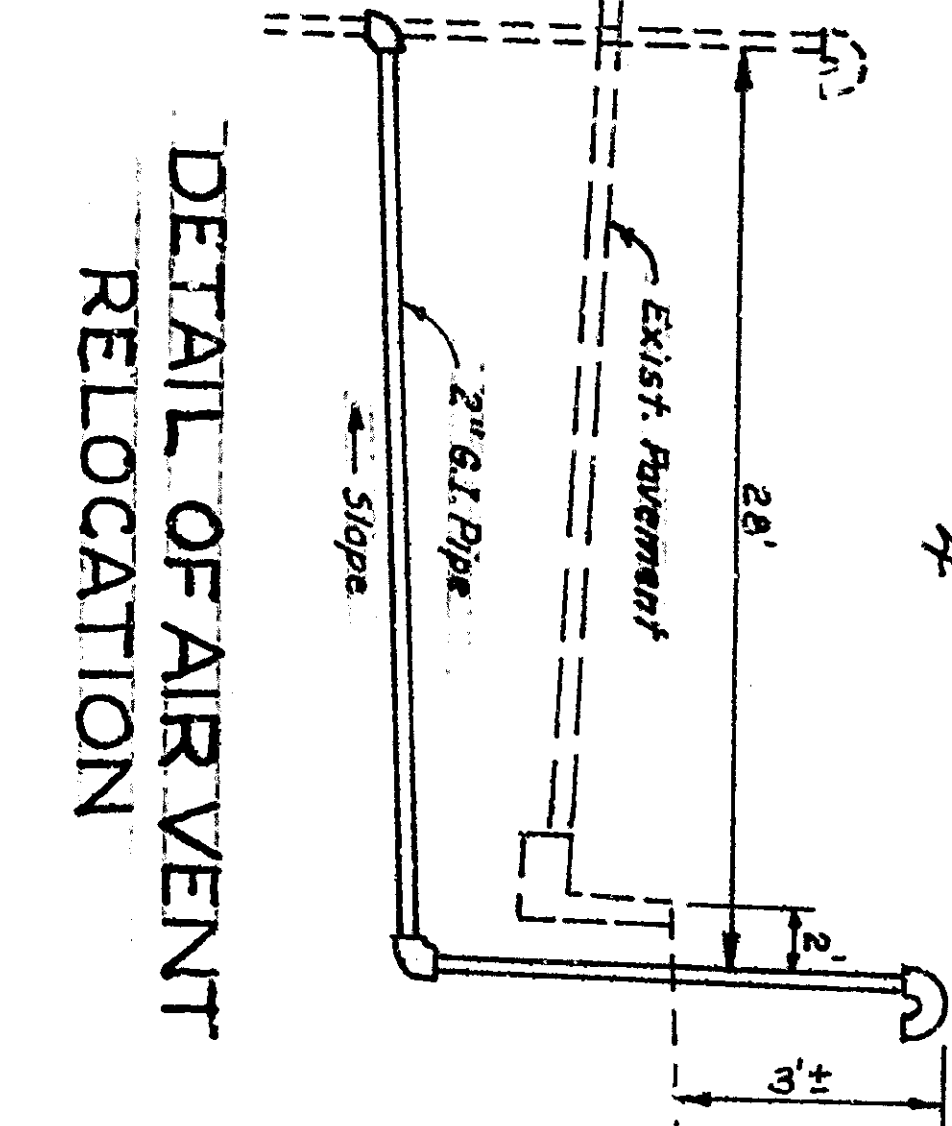

PROFILE
 1/2" HORIZ.
 1/4" VERT.

EL. 1355.00
 EL. 1355.00
 EL. 1355.00
 EL. 1365.00
 EL. 1365.00
 EL. 1365.00



NO. 1	RELOCATE AIR VENT	APPROVED	REVISION	DATE
1				
APPROVED: <i>[Signature]</i> 1964 REGISTERED CIVIL ENGINEER NO. 13053 DRAWING NO. 3344 CHECKED BY: <i>[Signature]</i> SHEET 1 OF RECOMMENDED 108 6 SHEETS				
CITY OF SAN BERNARDINO DEPARTMENT OF ENGINEERING APPROVAL: <i>[Signature]</i> MAY 5, 1964 DATE				
FORTIETH STREET Between Harrison Street and Mountain Avenue W.L. WILSON				

Stationing	Top of Curb	Top of Vent	Flow Line
0+00 E.C.	1355.92	1355.25	1355.92
1+00	1356.06	1355.39	1356.06
2+00	1356.82	1355.95	1356.82
3+00	1357.11	1356.44	1357.11
4+00	1357.70	1357.03	1357.70
5+00	1358.30	1357.63	1358.30
6+00	1358.92	1358.15	1358.92
7+00	1359.23	1358.36	1359.23
8+00	1359.37	1358.90	1359.37
9+00	1360.20	1360.03	1360.20

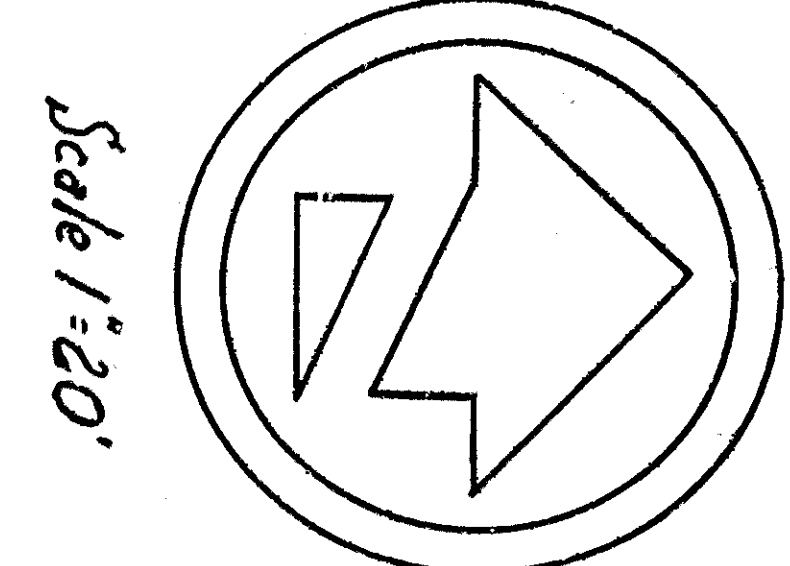

PROFILE
 1/4" = 1'-0"
 1/8" = 1'-0"